

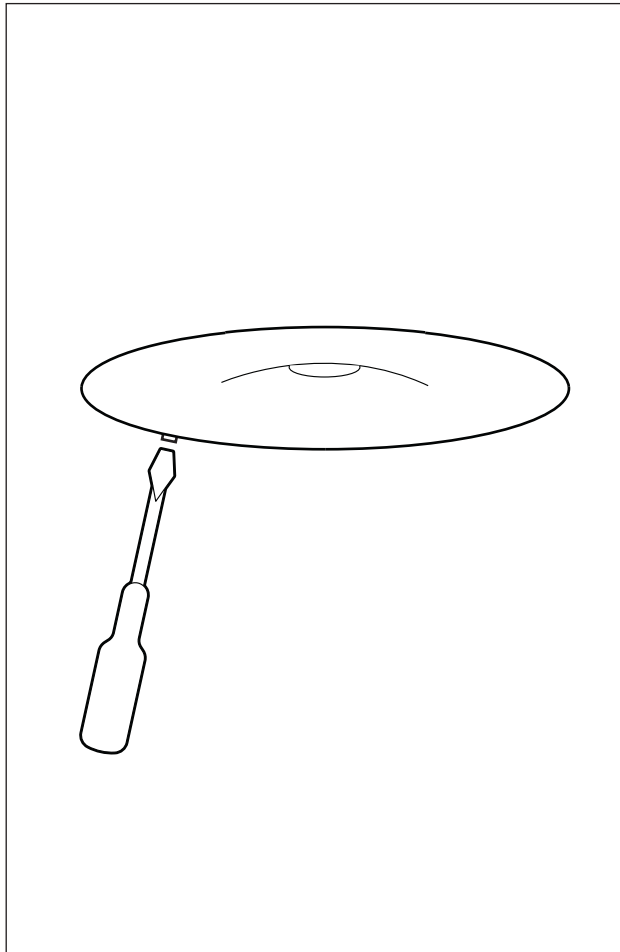

## STEP 7

- To disassemble the spot, use a voltage finder to pry the spot up in the open lip of the plastering.





# INSTUCTION MUNAL

## MOUNTING CONSTRUCTION PLASTER RING - GLARELESS SPOT

### STEP 1

- Drill a hole in the ceiling with a hole saw of  $\varnothing 88\text{mm}$ . Keep in mind the total width of the ring is 130 mm.

#### NECESSITIES

- Hole saw -  $\varnothing 88\text{mm}$
- Drill

### STEP 2

- Attach the wooden ring with the adhesive strip around the drill hole above the ceiling.

#### NECESSITIES

- Two half wooden rings

### STEP 3

- Place the plastering in the drill hole and screw the plastering tight with drywall screw.

#### NECESSITIES

- 5 times recessed drywall screws
- Screwdriver

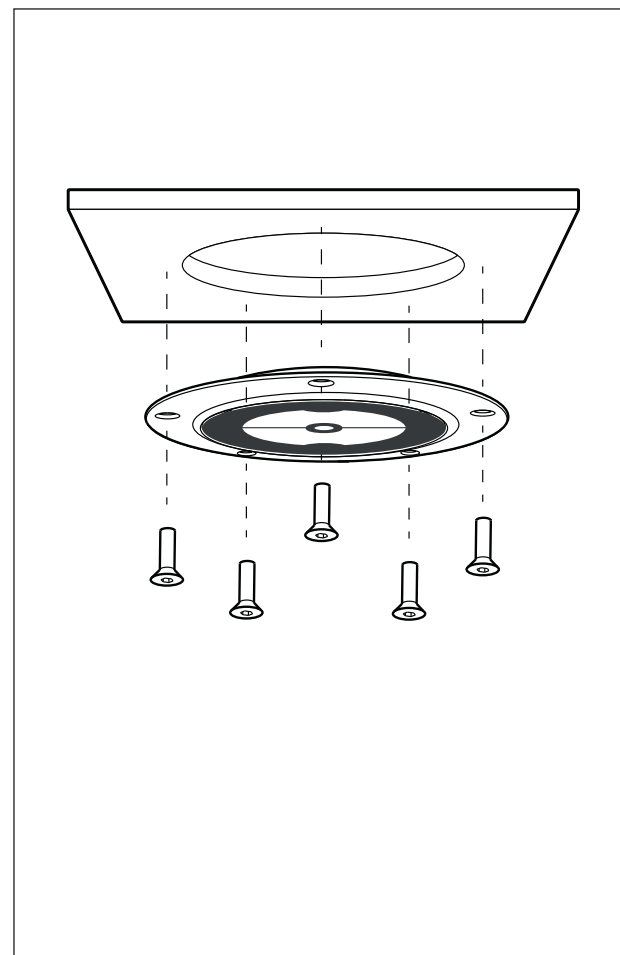
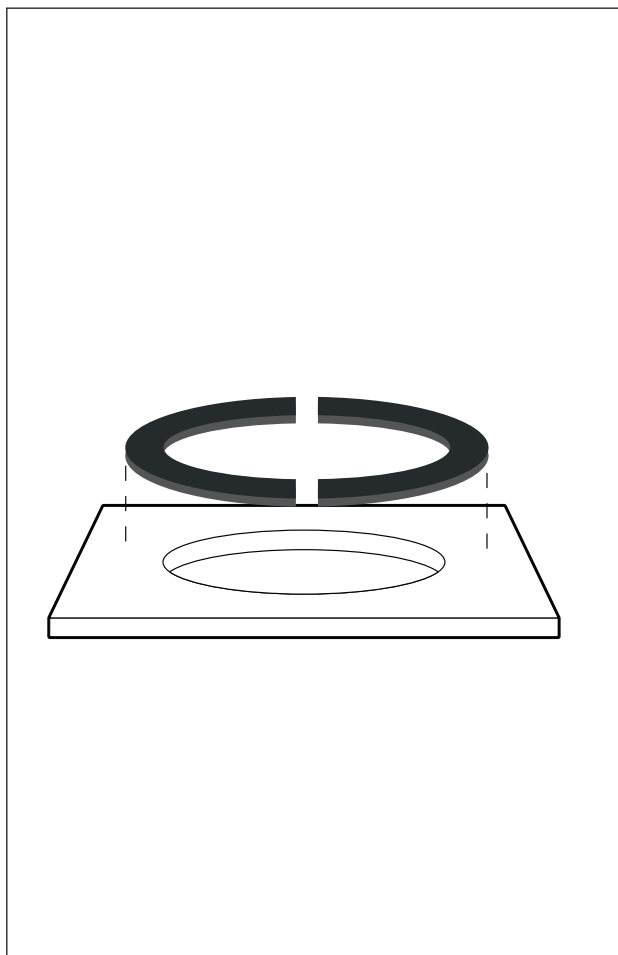
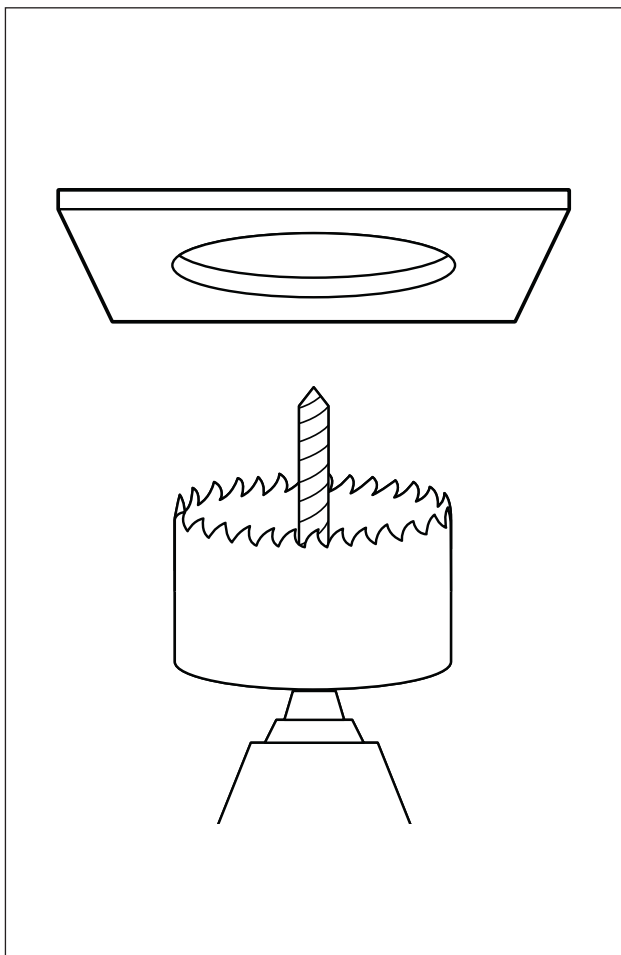



# INSTUCTION MUNAL

MOUNTING CONSTRUCTION PLASTER RING - GLARELESS SPOT

## STEP 4

- Plaster the ceiling

NOTE: MAKE SURE THAT THE PLASTER IS GREASED UP TO THE UPPER EDGE OF THE PLASTER RING AND LEAVE THE BLACK COVER IN THE RING DURING PLASTERING.

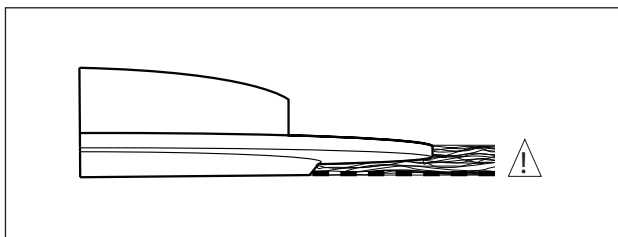
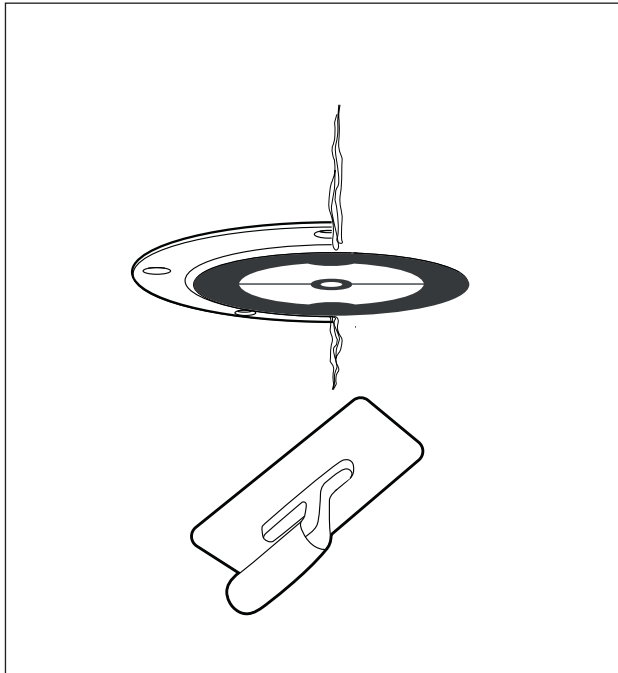

## STEP 5

- After the plastering has been completed, the black cover can be removed. Pierce a hole with a screwdriver in the center of the black cover and carefully pry it out of the plaster ring.

CAUTION: CLEAN THE INSIDE OF THE PLASTER RING AFTER THE BLACK COVER HAS BEEN REMOVED.

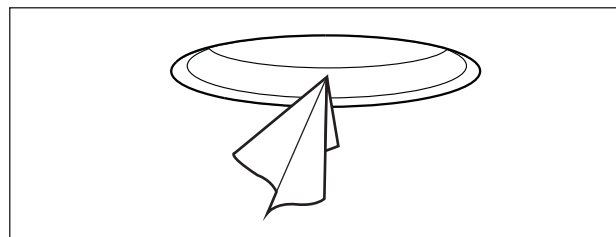
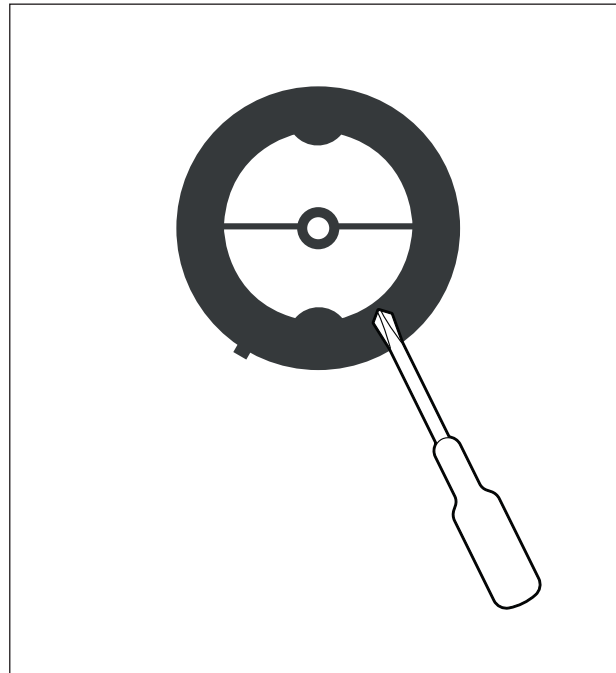

## STEP 6

- Look for the cabling of the spot in the datasheet on the website via the QR code on the last page.
- Press the spot into the plastering.

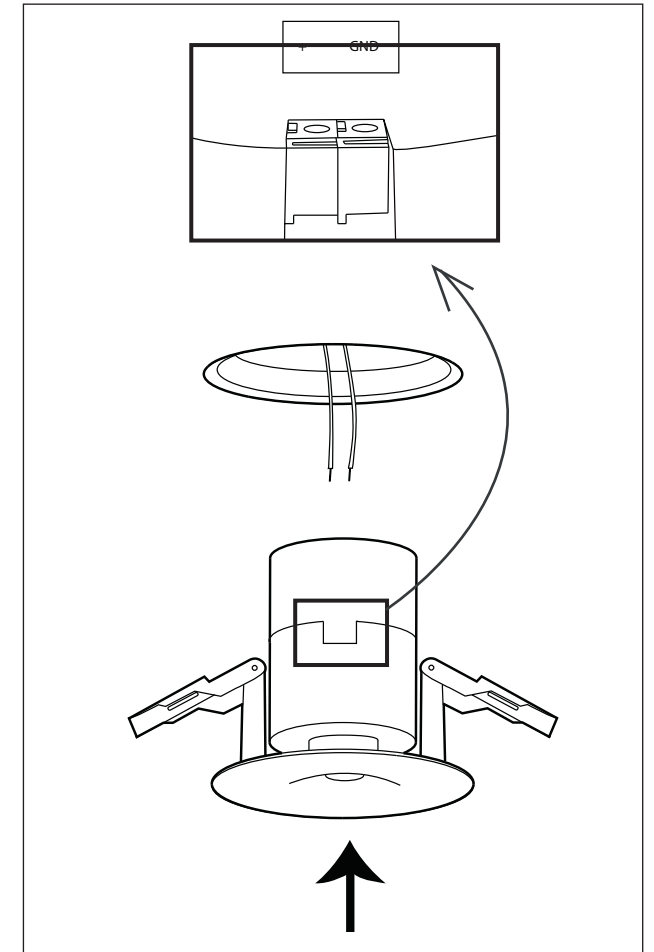



# COMPATIBILITY TABLE

MOUNTING CONSTRUCTION FOR LED-SPHERE

## DRIVERS AND ENGINES

	EXTERNAL DRIVER				INTERNAL DRIVER	
	CASAMBI	DMX	DALI	0-10 VOLT	CASAMBI	DMX
GLARELESS SPOT SINGLE WHITE	X	X	X	X		
GLARELESS SPOT DUAL WHITE/ WARM DIMMING	X		X		X	X
GLARELESS SPOT DUAL WHITE / TUNABLE WHITE	X	X	X		X	X
GLARELESS SPOT RGB+W					X	X
LED-SPHERE BASIC DUAL WHITE/ DUAL WHITE					X	X
LED-SPHERE PREMIUM RGB+W/ DUAL WHITE					X	X
LED-SPHERE ULTIMATE RGB+W/ RGB+W					X	X
POWERLINE SINGLE WHITE	X				X	X
POWERLINE DUAL WHITE / WARM DIMMING					X	
POWERLINE DUAL WHITE/ TUNABLE WHITE					X	X
POWERLINE RGBW+W					X	X
OUTDOOR ENGINE					X	

## MANUALS

[WWW.DYDELL.COM](http://WWW.DYDELL.COM)

Want to know more about the wiring and connecting the engine to the driver? Scan the QR code below to go to the instruction page on our website. Is the QR code not working? Copy this link: <https://www.dydell.com/nl/video-instructies-handleidingen/> into your browser.



**DYDELL**  
L I G H T